

LATITUDE & LONGITUDE = 22.569943 & 88.461210

West Bengal Housing Board
Constituted Attorney of
BENGAL MERLIN HOUSING LTD.
Director
Dilip Choudhury
Dilip Choudhury

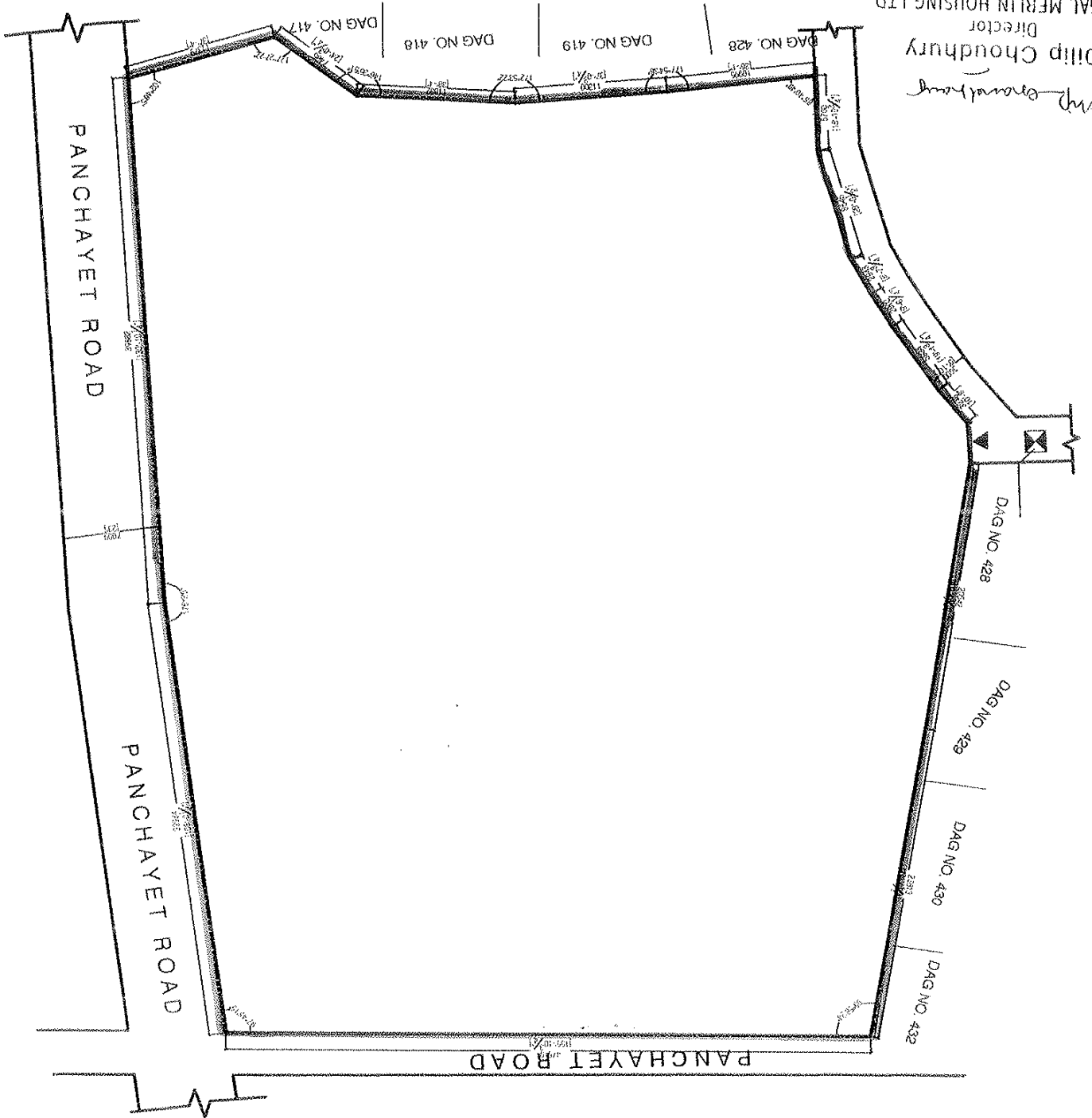

DEED PLAN OF ALL THAT THE PLOT OF LAND COMPRISING IN DAG NOS.
- 412, 413, 414, 415, & 416 BEING RS/HAL, L.R. KHATTAN NO. - 1220,
MOUZA THAKDARI, J.L. NO. - 19, UNDER NO. 2 GRAM PANCHAYET, P.S.
- NEW TOWN, DIST.-24 PARAGANAS(N) UNDER NORTH 24 PARAGANAS
ZILLA PARISHAD, MEASURING 106 DECIMALS.

